

CORE MATERIAL
 Columbia Forest Products (CFP) - PureBond Plywood with no Urea-Formaldehyde added during the manufacturing process.

DOOR & DRAWER EDGING
 Environmentally friendly 3mm ABS NaturEdge grain-through edgebanding, machine applied.

DRAWER SLIDES
 Regular extension 100 lb. load rated, epoxy powder coated steel.

HINGE & CABINET FACE STYLE
 165° concealed (6) way adjustable, full overlay design

BODY FRONT EDGING
 .20mm ABS edgebanding, machine applied

LAMINATING ADHESIVES
 Water based low VOC, non-toxic, PVA adhesives.

PRODUCT LABELING
 Finished products will be appropriately labeled to indicate FSC and CARB compliance.

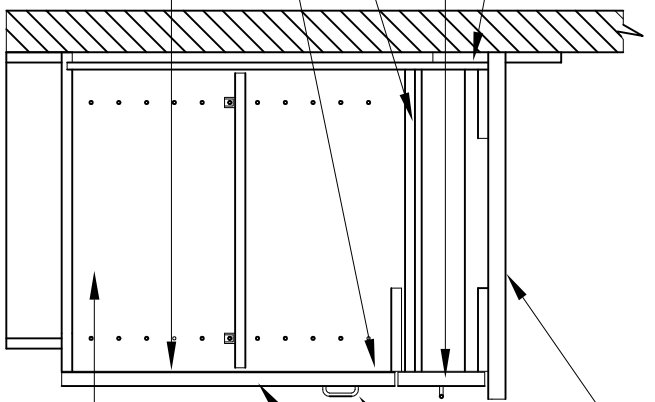

COUNTERTOP SURFACE MATERIAL
 GREENGUARD indoor Air Quality Certified HGS high-pressure decorate laminate.

COUNTERTOP EDGING
 Self edged GREENGUARD (same as above)

DOOR & DRAWER PULLS
 Metal wire, epoxy powder coated

FACE EXTERIOR SURFACE
 GREENGUARD Indoor Air Quality Certified VGS high pressure decorative laminate balanced with a CLS cabinet liner.

LOCKS
 Disc tumbler lock with removable core.

INTERIOR SURFACES
 White thermally fused melamine (TFM) laminate

PERFECT GREEN CASEWORK

PERFECTION

PERFECTION CABINETRY
TYPICAL.CABINET.SECTIONS
PERFECT GREEN

152 COUNTY ROAD 1297
 CULLMAN, ALABAMA 35058
 PHONE: 256-739-1958
 FAX: 256-734-1717

| | |
|------------|----------|
| PROJECT # | SECTIONS |
| DATE: | 20010-11 |
| REVISIONS: | |
| REV1 | |
| REV2 | |
| REV3 | |
| DRAWN BY: | 2M19 |
| DRAWING# | SECTIONS |
| PAGE# | S. 1 |